

Spit Grip Lip & Grip Drop-in Anchors

A broad range of internally threaded anchors for bolts and threaded rod.

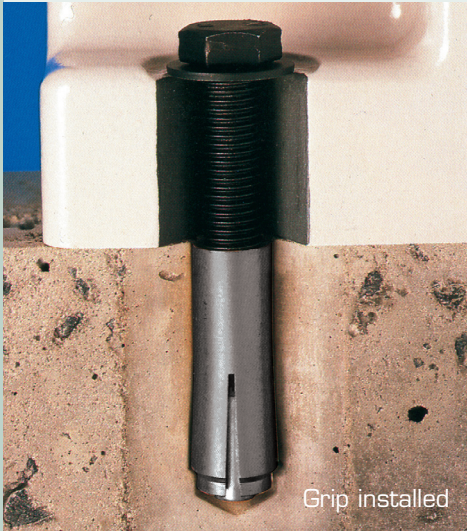

Substrates

- Concrete
- Solid stone

Applications

- Mechanical and electrical services
- Cable trays
- Pipe work
- Ventilation ducts
- Suspended ceilings
- Handrails
- Stadium seating
- Cable management

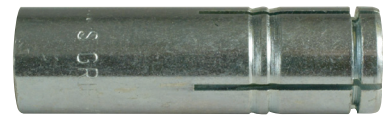
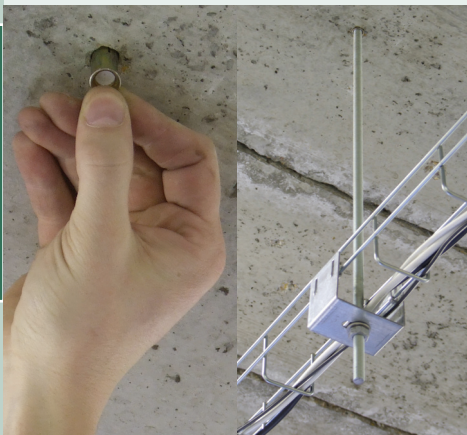

Features and Advantages

Spit Grip Lip:

- **Retainer lip** - Keeps the anchor flush with the surface, not dependent on hole depth
- Lip allows installation into hollow materials
- **Cone insert** - Expands the anchor when driven with setting tool and hammer
- **Reduced diameter** - For easier setting
- M10 x 30 - Now available for shallow embedment to avoid contact with rebar
- Internal thread has a modified expansion angle - Making expansion in hard materials easier and more effective
- **White zinc coating** - 7 microns

Spit Grip Stainless Steel:

Stainless steel version for external use.

Spit Grip:

A competitively priced alternative in the Drop-in range.

Installation

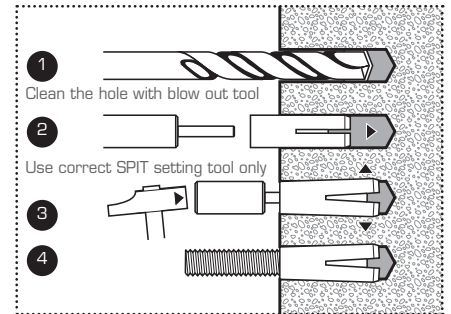

Technical Specification

Female, internally threaded, hammer set anchor. Flush fix design is pre-set by inserting into the drilled hole and hammering the internal expansion cone inside the body of the anchor using the setting tool.

Spit Grip Lip

Body steel S300 Pb NFA 35 - 561, expansion cone FB10 NFA 35 - 053.

Spit Grip Stainless Steel

Body stainless steel A4 X5 Cr Ni Mo 17-12-2, expansion cone stainless steel A4 X5 Cr Ni Mo 17-12-2.

ETA - European Technical Approval

ETA option 7 for non-cracked concrete.

Setting Tools



- **ST-M Manual Setting Tool**
Ergonomic handle for better grip
Guards against hand injuries
- **ST-RH Rotary Hammer Setting Tool**
For high-volume users
Visual verification of full expansion
- **Stainless Steel Setting Tool**



Spit Grip Lip - Zinc Plated



Eurocode	Thread \varnothing	Drill \varnothing	Overall Anchor Length	Thread Length	Drilling Depth	Max Tightening Torque	Box Qty	ST-M Manual Setting Tool	ST-RH Rotary Hammer Setting Tool
050789	M6	8mm	30mm	13mm	32mm	5Nm	100		
050790	M8	10mm	30mm	12mm	33mm	10Nm	100	050922 M6 x 30mm	050928 M6 x 30mm
050799	M10	12mm	30mm	11mm	33mm	22Nm	100	050923 M8 x 30mm	050929 M8 x 30mm
050791	M10	12mm	40mm	15mm	43mm	22Nm	100	051015 M10 x 30mm	-
050792	M12	15mm	50mm	21mm	54mm	36Nm	50	050924 M10 x 40mm	050930 M10 x 40mm
050793	M16	20mm	65mm	28mm	70mm	80Nm	20	050925 M12 x 50mm	050931 M12 x 50mm
								050926 M16 x 65mm	-

Spit Grip - Zinc Plated



Eurocode	Thread \varnothing	Drill \varnothing	Overall Anchor Length	Thread Length	Drilling Depth	Max Tightening Torque	Box Qty	ST-M Manual Setting Tool	ST-RH Rotary Hammer Setting Tool
062010	M6	8mm	30mm	13mm	32mm	5Nm	100		
062020	M8	10mm	30mm	13mm	32mm	10Nm	100	050922 M6 x 30mm	050928 M6 x 30mm
062330	M10	12mm	40mm	15mm	42mm	22Nm	100	050923 M8 x 30mm	050929 M8 x 30mm
062390	M12	15mm	50mm	18mm	53mm	36Nm	50	050924 M10 x 40mm	050930 M10 x 40mm
062470	M16	20mm	65mm	23mm	70mm	80Nm	20	050925 M12 x 50mm	050931 M12 x 50mm
								050926 M16 x 65mm	-

Spit Grip - Stainless Steel A4-316



Eurocode	Thread \varnothing	Drill \varnothing	Overall Anchor Length	Thread Length	Drilling Depth	Max Tightening Torque	Box Qty	Stainless Steel Setting Tool
062240*	M6	8mm	30mm	13mm	32mm	32Nm	100	
062250	M8	10mm	30mm	13mm	32mm	32Nm	100	050214 M6 x 30mm
062260	M10	12mm	40mm	15mm	42mm	42Nm	50	050215 M8 x 30mm
062270	M12	15mm	50mm	18mm	53mm	53Nm	50	050216 M10 x 40mm
062280	M16	20mm	65mm	23mm	70mm	70Nm	25	050217 M12 x 50mm
								050218 M16 x 65mm

*Order to order only.

Scaffold Ring Bolt



Eurocode	Thread \varnothing	Drill \varnothing	Eye \varnothing	Length Qty	Box
997120	M16	20mm	53mm	210mm	1